

COMAND

3



Fastdrill

Programma generale di foratura e lamatura
Tools for boring and spot-facing
Outils de perçage et de lamage
Bohr- und Senkwerkzeuge



Fastdrill**Fastdrill**

Punte ad inserti multi diametro	<i>pag. 3-3</i>
---------------------------------	-----------------

Fastdrill 2xD

Punte ad inserto 2xD prealesatura - LCMX	<i>pag. 3-4</i>
--	-----------------

Punte ad inserto 2xD prealesatura - WCMX	<i>pag. 3-5</i>
--	-----------------

Fastdrill 3xD

Punte ad inserto 3xD - LCMX	<i>pag. 3-6</i>
-----------------------------	-----------------

Punte ad inserto 3xD - LCMX	<i>pag. 3-7</i>
-----------------------------	-----------------

Punte ad inserto 3xD - WCMX	<i>pag. 3-8</i>
-----------------------------	-----------------

Punte ad inserto 3xD - WCMX	<i>pag. 3-9</i>
-----------------------------	-----------------

Speedbore

Fresa per lamatura - ECMT	<i>pag. 3-10</i>
---------------------------	------------------

Fresa per lamatura - ECMT	<i>pag. 3-11</i>
---------------------------	------------------

SET SB825

Fresa per lamatura viti a brugola	<i>pag. 3-12</i>
-----------------------------------	------------------



Multi range insert drills
Forets à plaquettes à diamètre multiple
Mehrbereichs - Vollbohrer

Fastdrill

Punte ad inserti multi diametro

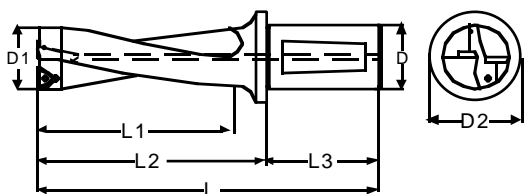

X= Disassamento Max

Codice	Dimensioni mm								Inserto	Parti di Ricambio	
	D	X	D1	D2	L	L1	L2	L3			
FD02D1824 R/L	18-24	3	25	35	114	47	64	50	LCMX07	TX2206	CTX06
FD02D2430 R/L	24-30	3	25	35	133	62	83	50	WCMX05	TX2206	CTX06
FD02D3038 R/L	30-38	4	25	35	154	77	104	50	WCMX06	TX3007	CTX08
FD02D3945 R/L	39-45	3	32	42	188	100	128	60	WCMX08	TX3509	CTX15
FD02D4550 R/L	45-50	2,5	40	50	203	115	133	70	WCMX08	TX4010	CTX15
Inserto	a	b	s	f	r						
LCMX070304	7	9	3	2.5	0.4						
WCMX050308	7.94	5.07	3.18	3.2	0.8						
WCMX06T308	9.52	6.17	3.97	3,7	0.8						
WCMX080408	12.7	8.17	4.76	4.3	0.8						

Tolleranza D= ± 0.2 mm

Attacco - Shank ISO 9766

Fastdrill

Fastdrill 2xD

Insert drills 2xD drill depth
Forets à plaquettes 2xD préalésage
Vollbohrer 2xD Bohrtiefe

Punte ad inserto 2xD prealesatura

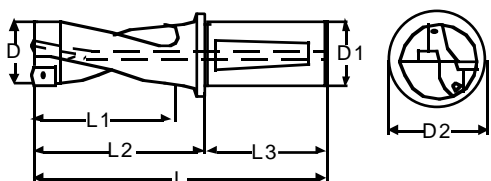

Diametro punta, D 11,7-25,7 mm
Tolleranza, D ± 0.15 mm
Max, prof. foratura L1 2xD

Codice	Dimensioni mm							Inserto	Parti di Ricambio	
	D	D1	D2	L	L1	L2	L3			
FD02D117	11.7	20	25	78	26	38	40	LCMX05	TX2005	CTX06
FD02D127	12.7	20	25	81	28	41	40	LCMX05	TX2005	CTX06
FD02D137	13.7	20	25	84	30	44	40	LCMX05	TX2005	CTX06
FD02D147	14.7	20	25	87	32	47	40	LCMX05	TX2005	CTX06
FD02D157	15.7	20	25	90	34	50	40	LCMX05	TX2005	CTX06
FD02D167	16.7	20	25	93	36	53	40	LCMX05	TX2005	CTX06
FD02D177	17.7	25	35	103	38	53	50	LCMX07	TX2207	CTX07
FD02D187	18.7	25	35	106	40	56	50	LCMX07	TX2207	CTX07
FD02D197	19.7	25	35	109	42	59	50	LCMX07	TX2207	CTX07
FD02D207	20.7	25	35	112	44	62	50	LCMX07	TX2207	CTX07
FD02D217	21.7	25	35	115	46	65	50	LCMX07	TX2207	CTX07
FD02D227	22.7	25	35	118	48	68	50	LCMX07	TX2207	CTX07
FD02D237	23.7	25	35	121	50	71	50	LCMX07	TX2207	CTX07
FD02D247	24.7	25	35	124	52	74	50	LCMX07	TX2207	CTX07
FD02D257	25.7	25	35	127	54	77	50	LCMX07	TX2207	CTX07
Inserto	a	b	s	f	r					
LCMX050204	5	7	2.5	2.2	0.4					
LCMX070304	7	9	3	2.5	0.4					

Attacco - Shank ISO 9766

Fastdrill 2xD



Insert drills 2xD drill depth
Forets à plaquettes 2xD préalésage
Vollbohrer 2xD Bohrtiefe

Fastdrill 2xD

Punte ad inserto 2xD prealesatura

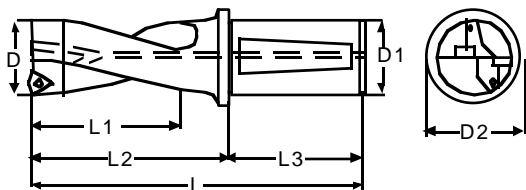

Diametro punta, D 26,7-39,7 mm
Tolleranza, D ± 0.2 mm
Max. prof. foratura L1 2xD

Codice	Dimensioni mm							Inserto	Parti di Ricambio	
	D	D1	D2	L	L1	L2	L3			
FD02D267	26.7	25	35	130	56	80	50	WCMX05	TX3007	CTX08
FD02D277	27.7	25	35	133	58	83	50	WCMX05	TX3007	CTX08
FD02D287	28.7	25	35	136	60	86	50	WCMX05	TX3007	CTX08
FD02D297	29.7	25	35	139	62	89	50	WCMX05	TX3007	CTX08
FD02D307	30.7	25	35	142	64	92	50	WCMX05	TX3007	CTX08
FD02D317	31.7	32	42	154	66	94	60	WCMX06	TX3508	CTX10
FD02D327	32.7	32	42	156	68	96	60	WCMX06	TX3508	CTX10
FD02D337	33.7	32	42	158	70	98	60	WCMX06	TX3508	CTX10
FD02D347	34.7	32	42	160	72	100	60	WCMX06	TX3508	CTX10
FD02D357	35.7	32	42	162	74	102	60	WCMX06	TX3508	CTX10
FD02D367	36.7	32	42	164	76	104	60	WCMX06	TX3508	CTX10
FD02D377	37.7	32	42	166	78	106	60	WCMX06	TX3508	CTX10
FD02D387	38.7	32	42	168	80	108	60	WCMX06	TX3508	CTX10
FD02D397	39.7	32	42	170	82	110	60	WCMX06	TX3508	CTX10
Inserto	a	b	s	f	r					
WCMX05	7.94	5	3.18	3.2	0.8					
WCMX06	9.52	6	3.97	3.7	0.8					

Attacco - Shank ISO 9766

Fastdrill 2xD



Fastdrill 3xD

Insert drills 3xD
Forets a plaquettes 3xD
Vollbohrer 3xD

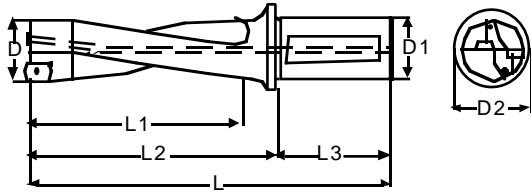
Punte ad inserto 3xD



Diametro punta, D 12-20 mm
Tolleranza, D ± 0.15 mm
Max, prof. foratura L1 3xD

Codice	Dimensioni mm							Inserto	Parti di Ricambio	
	D	D1	D2	L	L1	L2	L3			
FD03D120	12	20	25	92	38	52	40	LCMX05	TX2005	CTX06
FD03D125	12.5	20	25	94	41	54	40	LCMX05	TX2005	CTX06
FD03D127	12.7	20	25	94	41	54	40	LCMX05	TX2005	CTX06
FD03D130	13	20	25	95	42	55	40	LCMX05	TX2005	CTX06
FD03D135	13.5	20	25	96	43	56	40	LCMX05	TX2005	CTX06
FD03D140	14	20	25	98	45	58	40	LCMX05	TX2005	CTX06
FD03D145	14.5	20	25	100	46	60	40	LCMX05	TX2005	CTX06
FD03D150	15	20	25	102	48	62	40	LCMX05	TX2005	CTX06
FD03D155	15.5	20	25	104	50	64	40	LCMX05	TX2005	CTX06
FD03D160	16	20	25	106	51	66	40	LCMX05	TX2005	CTX06
FD03D165	16.5	20	25	108	53	68	40	LCMX05	TX2005	CTX06
FD03D170	17	20	25	109	54	69	40	LCMX05	TX2005	CTX06
FD03D175	17.5	25	35	121	56	71	50	LCMX07	TX2207	CTX07
FD03D180	18	25	35	121	56	71	50	LCMX07	TX2207	CTX07
FD03D185	18.5	25	35	125	59	75	50	LCMX07	TX2207	CTX07
FD03D190	19	25	35	125	59	75	50	LCMX07	TX2207	CTX07
FD03D195	19.5	25	35	129	62	79	50	LCMX07	TX2207	CTX07
FD03D200	20	25	35	129	62	79	50	LCMX07	TX2207	CTX07

Attacco - Shank ISO 9766

Fastdrill 3xD



Insert drills 3xD
Forets à plaquettes 3xD
Vollbohrer 3xD

Fastdrill 3xD

Punte ad inserto 3xD

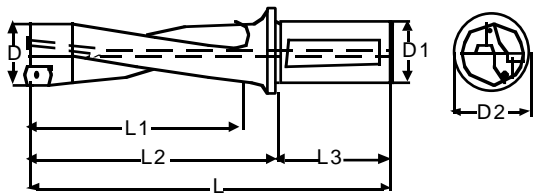

Diametro punta, D 21-26 mm
Tolleranza, D ± 0.15 mm
Max. prof. foratura L1 3xD

Codice	Dimensioni mm							Inserto	Parti di Ricambio	
	D	D1	D2	L	L1	L2	L3			
FD03D210	21	25	35	133	65	83	50	LCMX07	TX2207	CTX07
FD03D220	22	25	35	137	68	87	50	LCMX07	TX2207	CTX07
FD03D230	23	25	35	141	71	91	50	LCMX07	TX2207	CTX07
FD03D240	24	25	35	145	74	95	50	LCMX07	TX2207	CTX07
FD03D250	25	25	35	149	77	99	50	LCMX07	TX2207	CTX07
FD03D260	26	25	35	153	80	103	50	LCMX07	TX2207	CTX07
Inserto	a	b	s	f	r					
LCMX050204	5	7	2.5	2.2	0.4					
LCMX070304	7	9	3	2.5	0.4					

Attacco - Shank ISO 9766



Fastdrill 3xD



COMAND

Fastdrill 3xD

Insert drills 3xD
Forets à plaquettes 3xD
Vollbohrer 3xD

Punte ad inserto 3xD

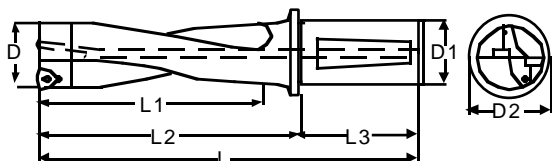

Diametro punta, D 27-45 mm
Tolleranza, D ± 0.2 mm
Max, prof. foratura L1 3xD

Codice	Dimensioni mm							Inserto	Parti di Ricambio	
	D	D1	D2	L	L1	L2	L3			
FD03D270	27	25	35	157	83	107	50	WCMX05	TX3007	CTX08
FD03D280	28	25	35	161	86	111	50	WCMX05	TX3007	CTX08
FD03D290	29	25	35	165	89	115	50	WCMX05	TX3007	CTX08
FD03D300	30	25	35	169	92	119	50	WCMX05	TX3007	CTX08
FD03D310	31	25	35	173	95	123	50	WCMX05	TX3007	CTX08
FD03D320	32	32	42	186	98	126	60	WCMX06	TX3508	CTX10
FD03D330	33	32	42	189	101	129	60	WCMX06	TX3508	CTX10
FD03D340	34	32	42	192	104	132	60	WCMX06	TX3508	CTX10
FD03D350	35	32	42	195	107	135	60	WCMX06	TX3508	CTX10
FD03D360	36	32	42	198	110	138	60	WCMX06	TX3508	CTX10
FD03D370	37	32	42	201	113	141	60	WCMX06	TX3508	CTX10
FD03D380	38	32	42	204	116	144	60	WCMX06	TX3508	CTX10
FD03D390	39	32	42	207	119	147	60	WCMX06	TX3508	CTX10
FD03D400	40	32	42	210	122	150	60	WCMX06	TX3508	CTX10
FD03D410	41	40	50	213	125	143	70	WCMX08	TX4010	CTX15
FD03D420	42	40	50	216	128	146	70	WCMX08	TX4010	CTX15
FD03D430	43	40	50	219	131	149	70	WCMX08	TX4010	CTX15
FD03D440	44	40	50	222	134	152	70	WCMX08	TX4010	CTX15
FD03D450	45	40	50	225	137	155	70	WCMX08	TX4010	CTX15

Attacco - Shank ISO 9766

Fastdrill 3xD



Insert drills 3xD
Forets à plaquettes 3xD
Vollbohrer 3xD

Fastdrill 3xD

Punte ad inserto 3xD

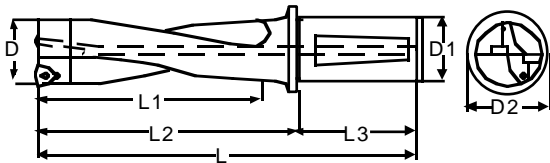

Diametro punta, D 46-58 mm
Tolleranza, D ± 0.2 mm
Max, prof. foratura L1 3xD

Codice	Dimensioni mm							Inserto	Parti di Ricambio	
	D	D1	D2	L	L1	L2	L3			
FD03D460	46	40	50	228	140	158	70	WCMX08	TX4010	CTX15
FD03D470	47	40	50	231	143	161	70	WCMX08	TX4010	CTX15
FD03D480	48	40	50	234	146	164	70	WCMX08	TX4010	CTX15
FD03D490	49	40	60	237	149	167	70	WCMX08	TX4010	CTX15
FD03D500	50	40	60	240	152	170	70	WCMX08	TX4010	CTX15
FD03D510	51	40	60	243	155	173	70	WCMX08	TX4010	CTX15
FD03D520	52	40	60	246	158	176	70	WCMX08	TX4010	CTX15
FD03D530	53	40	60	249	161	179	70	WCMX08	TX4010	CTX15
FD03D540	54	40	60	252	164	182	70	WCMX08	TX4010	CTX15
FD03D550	55	40	60	255	167	185	70	WCMX08	TX4010	CTX15
FD03D560	56	40	60	258	170	188	70	WCMX08	TX4010	CTX15
FD03D570	57	40	60	261	173	191	70	WCMX08	TX4010	CTX15
FD03D580	58	40	60	264	176	194	70	WCMX08	TX4010	CTX15
Inserto	a	b	s	f	r					
WCMX050308	7.94	5.07	3.18	3.2	0.8					
WCMX06T308	9.52	6.7	3.97	3.7	0.8					
WCMX080408	12.7	8.7	4.76	4.9	0.8					

Attacco - Shank ISO 9766

Fastdrill 3xD

COMAND

Speedbore

Fresa per lamatura

Spot facing milling cutter
Fraise à lamer
Wendeplatten - Fräsenker

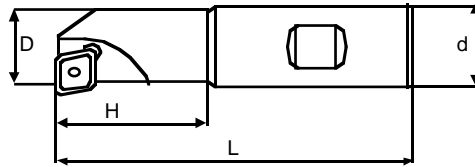
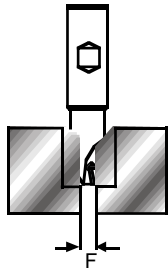

Speedbore

Codice	Dimensioni mm						Inserto	Parti di Ricambio	
	D	d	H	L	Z	F			
SB08M04	08	12	15	85	1	4	EPMT0502	TX2206	BTX06
SB09M05	09	12	15	85	1	4.5	EPMT0502	TX2206	BTX06
SB10	10	12	15	85	1	5	ECMT0602	TX2506	BTX08
SB11M06	11	12	15	85	1	5.5	ECMT0602	TX2506	BTX08
SB12	12	12	20	85	1	6	ECMT0602	TX2506	BTX08
SB13	13	12	20	85	1	6.5	ECMT0602	TX2506	BTX08
SB14M08	14	12	20	85	1	7	ECMT0602	TX2506	BTX08
SB15	15	12	20	85	1	7.5	ECMT0602	TX2506	BTX08
SB16	16	16	30	95	1	8	ECMT0803	TX3007	BTX08
SB17M10	17	16	30	95	1	8.5	ECMT0803	TX3007	BTX08
SB18	18	16	30	95	1	9	ECMT0803	TX3007	BTX08
SB19M12	19	16	30	95	1	9.5	ECMT0803	TX3007	BTX08
SB20	20	16	30	95	1	10	ECMT0803	TX3007	BTX08
SB21	21	16	30	95	1	10.5	ECMT0803	TX3007	BTX08
SB22M14	22	16	30	95	1	11	ECMT0803	TX3007	BTX08
SB23	23	16	30	95	1	11.5	ECMT0803	TX3007	BTX08
SB24	24	16	30	95	1	12	ECMT0803	TX3007	BTX08
SB25M16	25	16	30	95	1	12.5	ECMT0803	TX3007	BTX08
SB26	26	16	30	95	1	13	ECMT0803	TX3007	BTX08
SB27	27	16	30	95	1	13.5	ECMT0803	TX3007	BTX08

Attacco - Shank DIN 1835B



Spot facing milling cutter
 Fraise à lamer
 Wendeplatten - Fräsenker

Speedbore

Fresa per lamatura

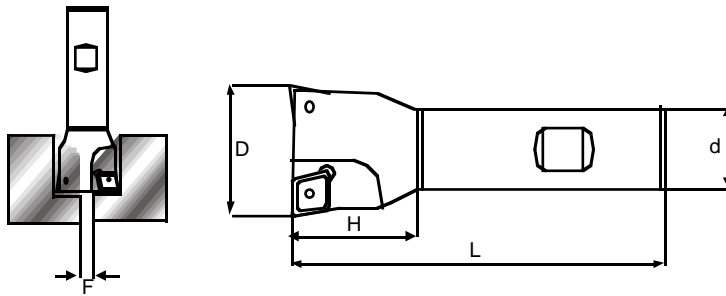

Codice	Dimensioni mm						Inserto	Parti di Ricambio	
	D	d	H	L	Z	F			
SB28M18	28	20	30	95	2	14	ECMT0803	TX3007	BTX08
SB29	29	20	30	95	2	14.5	ECMT0803	TX3007	BTX08
SB30	30	20	30	95	2	15	ECMT0803	TX3007	BTX08
SB31M20	31	20	30	95	2	15.5	ECMT0803	TX3007	BTX08
SB32	32	20	30	95	2	16	ECMT0803	TX3007	BTX08
SB33	33	20	30	95	2	16.5	ECMT0803	TX3007	BTX08
Inserto	a	b	s	f	r				
EPMT050202	5.5	5.6	2.5	2.5	0.2				
ECMT060204	6.35	6.57	2.5	2.8	0.4				
ECMT080304	7.93	8.20	3.5	3.2	0.4				

Attacco - Shank DIN 1835B

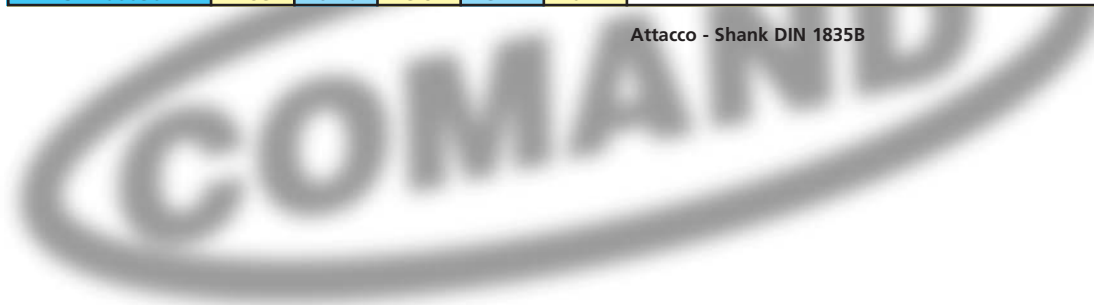

Speedbore



COMAND

SET SB825

Spot facing milling cutter for hexagonal screws
 Fraise à lamer pour vis Allen
 Fräsenker für Sechskantschrauben

Fresa per lamatura viti a brugola



Set di lamatura serie Speedbore

N. 1 Speedbore SB08M04	N. 10 Inserti EPMT050202 CPR140
N. 1 Speedbore SB09M05	N. 10 Inserti ECMT060204 CPR140
N. 1 Speedbore SB11M06	N. 10 Inserti ECMT080304 CPR140
N. 1 Speedbore SB14M08	N. 1 Vite TX2206
N. 1 Speedbore SB17M10	N. 1 Vite TX2506
N. 1 Speedbore SB19M12	N. 1 Vite TX3007
N. 1 Speedbore SB22M14	N. 1 Chiave CTX06
N. 1 Speedbore SB25M16	N. 1 Chiave CTX08
	N. 1 Espositore

Inserto	a	b	s	f	r
EPMT050202	5.5	5.6	2.5	2.5	0.2
ECMT060204	6.35	6.57	2.5	2.8	0.4
ECMT080304	7.93	8.20	3.5	3.2	0.4

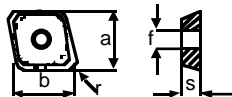

SET SB825



COMAND

Note

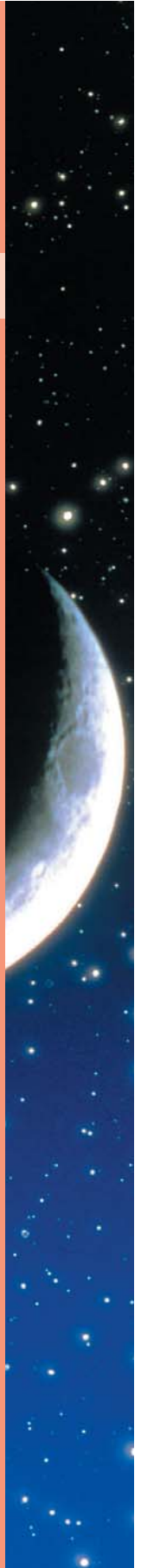

COMAND

Note

